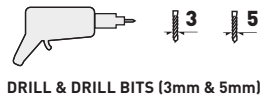
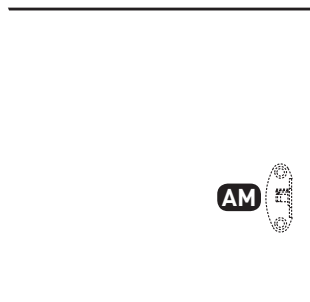
**MINIMUM TOOLS REQUIRED:**

**These instruction show how to fit the bridging stay to the LH side of your cabinet.
If you require the stay on the RH side, then you should mirror the end panel details.**

Certain door styles require a re-positioning of the hinge plates within the cabinet. In this instance, you should refer to the additional assembly guide contained within the door pack you have purchased.

STEP 1:

Fit bracket **AM** to the door in the pre-marked positions, with the axis pointing towards the inside of the cabinet, as shown, and secure using 2 x screws **D**.

**STEP 2:**

Insert the metal frame brackets, at an angle, into the holes in the back of the frame, and then straighten them up, to grip the holes, before fitting the frame.

Carefully push the frame (with brackets) onto the front of the cabinet, and adjust to the correct position.

Secure the frame brackets to the cabinet with screws **D**.

Finally, fit the door stop **AX** at the bottom of the frame, as required.

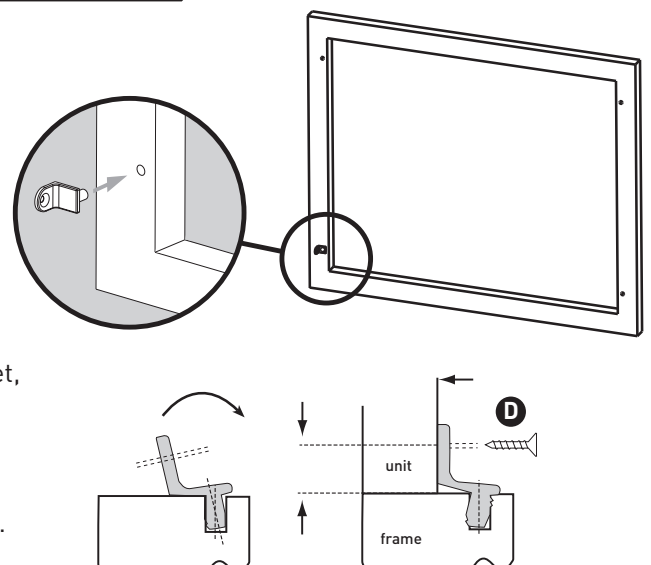

STEP 3:

Having fitted the frame, position the spacer **AP** onto the LH end panel, with the B holes visible, ensuring that its front edge is flush up against the frame brackets **AW**, and it is flush to the top panel of the cabinet.

Now secure spacer **AP** in place using screws **AV**.

Finally, fit bracket **AN** to the bottom of spacer **AP**, in the pre-marked B holes, as shown in the detail opposite, and secure using 2 x screws **D**.

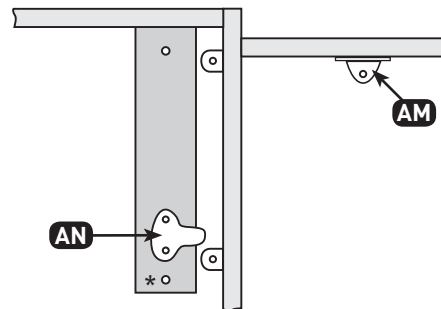
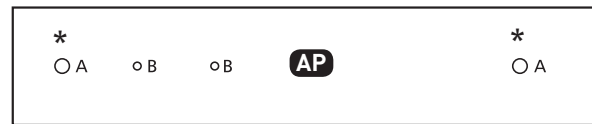
**STEP 4:**

Insert door hinge **AR** into rear recess in door

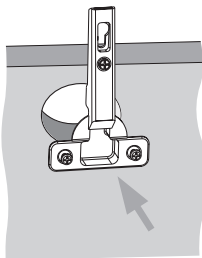

Affix hinge plate **AS** on cabinet

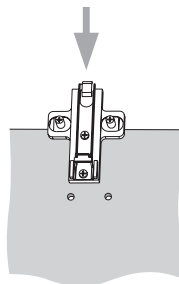

Now, clip hinge **AR** onto hinge plate **AS**.

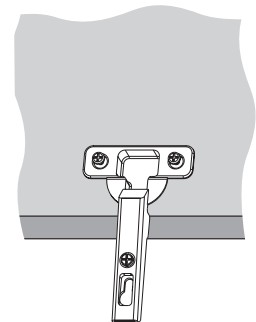

Turn screws as shown to adjust door position

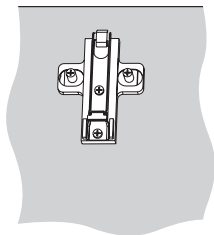
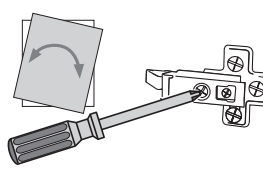
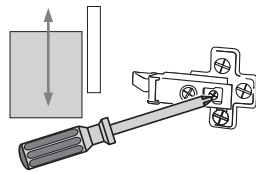
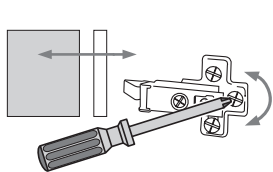

After adjustment is complete, apply cover plate **AD**.

STEP 5:

Fit door stay **AL** as shown.

The stay is designed to "click" onto the brackets **AM** and **AN**.

Finally, to increase or decrease the door stay force, use a 4mm allen key in adjustment screw as shown.

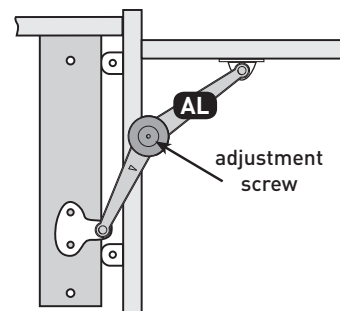
**STEP 6:**

Smove Fitting. When fitting the door stay **AL** to the LH end of the cabinet, the RH end will need to be drilled for the smove mounting block **AT**.

Mark 12mm on a 5mm drill bit, with masking tape. Now, carefully drill two holes, in the positions shown. The mounting block can then be fitted to these holes.

